

Nat. 66b.]

From Maori Welfare Officer,  
OPOTIKI.

The Registrar,  
Native Land Court,  
To ROTORUA.

N.D. 

|            |    |                                                                    |                                                           |
|------------|----|--------------------------------------------------------------------|-----------------------------------------------------------|
| H.O. file: | .. | D.O. file:                                                         |                                                           |
| Subject:   | .. | <u>Waioeka Lot 337A No. 2. Housing Application: WIREMU KOROUA.</u> |                                                           |
| Date:      | .. | <u>27/8/47.</u>                                                    | Previous ref.: Ours/Yours of <u>6</u> Enclosures checked: |

[50,000/1/46-1456

Further to a meeting held at Waioeka Pa with Judge Harvey I enclose herewith:

1. a. Application for a Vesting order.
- b. Application for Partition.

I understand that Judge Harvey will be able to include these applications in a supplementary panui for the sitting of the Court at Rotorua.

2. Application for an Advance and housing survey on this application.

My remarks accompany this application for the file of your Housing division. I understand that this application is to be treated with urgency so that we can catch the Waioeka people while they are swinging.



Maori Welfare Officer.

1093

0384

[N.L.C.—4.]

APPLICATION FOR PARTITION.

(RULE 29.)

*Te Ture Whenua Maori, 1931.*

KI TE KOOTI WHENUA MAORI.

**K**O matou ko nga tangata kua tuhi nei i o matou ingoa me a matou tohu ki raro nei, etahi o nga tangata no ratou te whenua e whakahuatia i raro nei, e tono ana ki te Kooti Whenua Maori kia roherohea taua whenua.

Ko te ingoa o taua whenua ko  
(Name of land)

WAIOTEKA 337 A No. 2

Takiwa o  
(District)

WAIOTEKA

Ko to matou kainga kei:  
(Residence)

WAIOTEKA

Ko te poutapeta ko:  
(Postal address)

WAIOTEKA O POUTIKA

He mea tuhi i te  
(Date)

26<sup>th</sup> o nga ra o AUGUST, 1937

Na

Me tuhituhi o kou-  
tou ingoa ki kona. 13  
Signature of  
Applicant.



*W. KOROUA*  
*6/9/37*  
*W. Koroua*

Advertised for

**SEARCH NOTE.**

*see appls 854*

Case No.

*854/37*

DISPOSAL.

Ordered:

Dismissed:

Adjourned:

M.B.

Fol.

Signature of Clerk of Court:



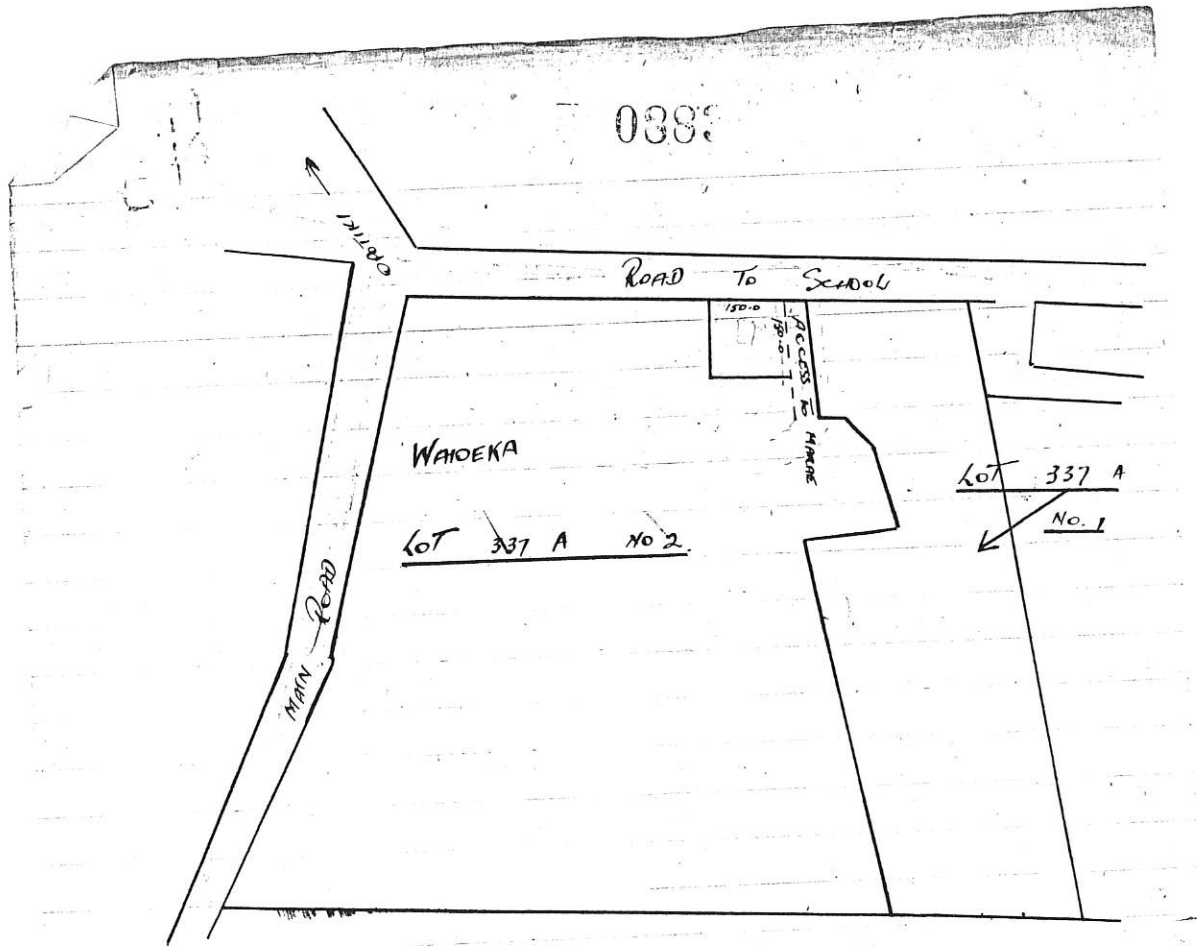

We, landowners and elders of Waioeka Pa, having met in a meeting on the 26th August 1947 at Waioeka, and having fully considered the requirements of initiating a housing scheme in this area, do hereby apply for an order vesting an area of 32 perches, more or less, in Wiremu Koroua for the purpose of providing the said Wiremu Koroua with a site for a dwelling, and we agree that the site for this dwelling shall be the area as marked on the sketch plan above: being to the west of the access lane leading to the marae from the school road, with a frontage of 150 links to the school road and 150 links to the marae lane.

Kurei Pahuhu  
 Hirihakae Hone.  
 Koroua Hira  
 Rau Tauhara Jamaipoo  
 X Iqakohu Pera  
 Iua Hudson.

*Witness*  
 5/9/47  
 26/11/07



(His mark) *Witness* R. Perry  
 CHAIRMAN KIHAKI-MARA TRIBAL EXECUTIVE

Signed by the above named in the presence of me, the undersigned and I hereby certify that they have a knowledge of the English language sufficient to enable them to understand and that they did understand the purport meaning and effect of the foregoing before they signed the same.

R. Perry - 26. 8. 47  
 NATIVE WELFARE OFFICER  
 NATIVE DEPT. OF THE GOVERNMENT

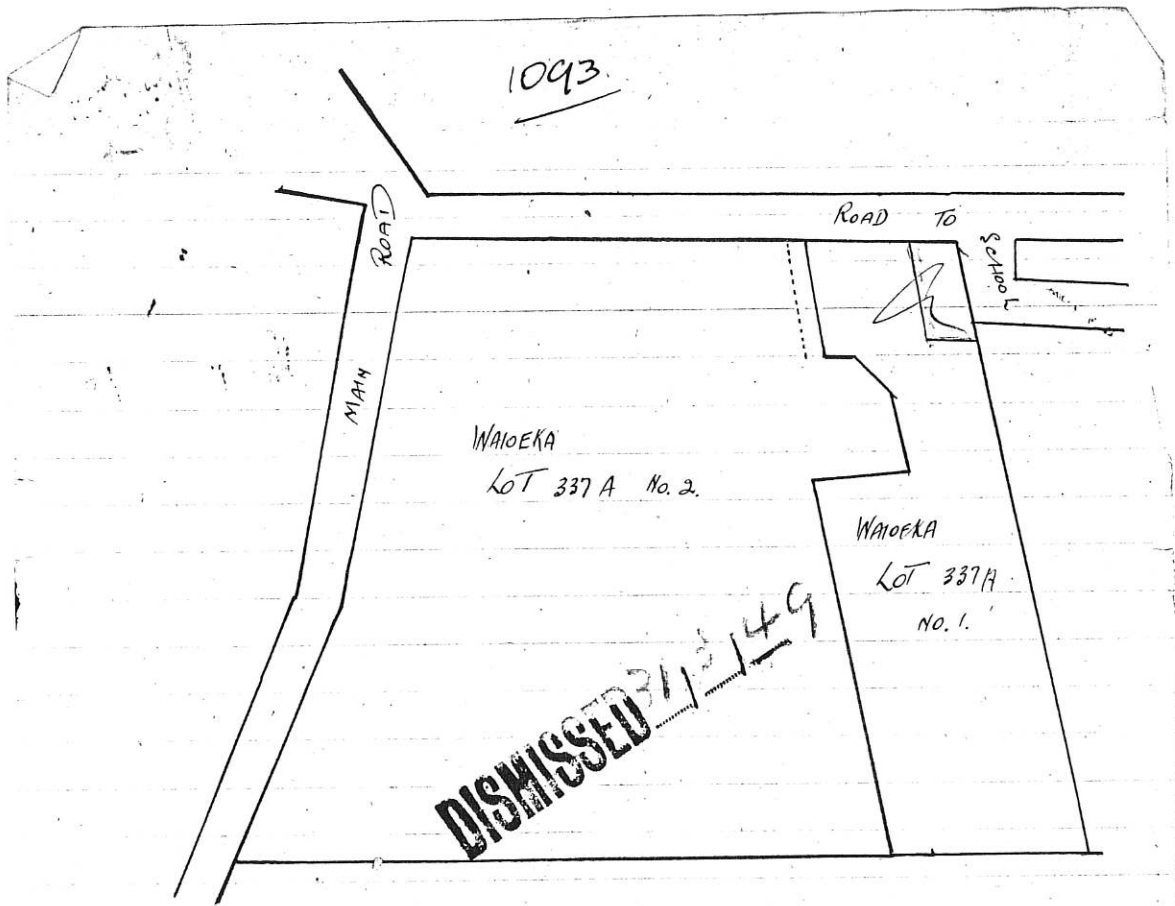

We, landowners and elders of Waioeka Pa Lot 337A No. 1, having fully considered the requirements of initiating a housing scheme in this area, do hereby apply for an order vesting an area of 32 perches, more or less, in Henry Tawhare for the purpose of providing the said Henry Tawhare with a site for a dwelling, and we agree that the site for this dwelling shall be the area as marked on the sketch plan above: being to the west of the road leading to the school with a frontage of 100 links and depth of 200 links.

Rau Tawhara Tamaitapa  
 Hurei Pakuhia  
 Henry M. Gregor

Lot 337A No 1B: Area 4-1-09  
 Parish of Waioeka

See Application for partition:

OPOTIKI  
 OPOTIKI

1 JUN 1948 - 62  
~~2 NOV 1947~~